

# ASSEMBLY INSTRUCTIONS

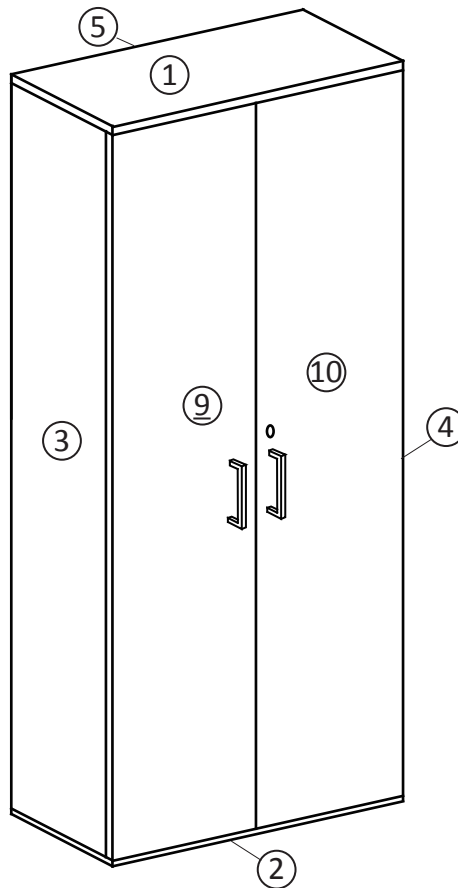
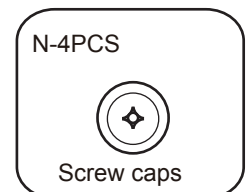
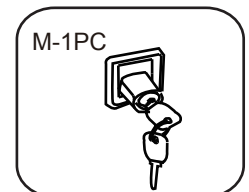
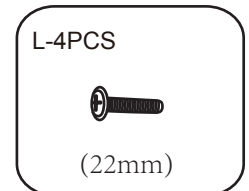
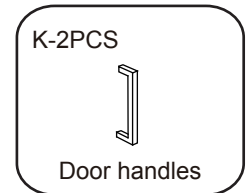
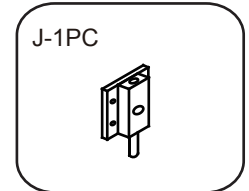
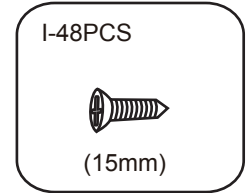
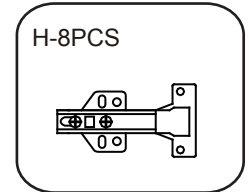
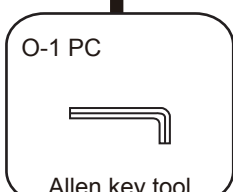
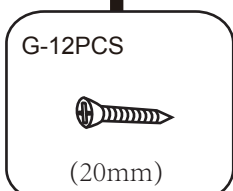
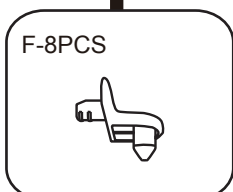
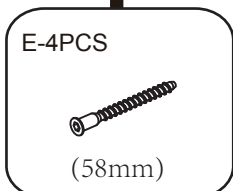
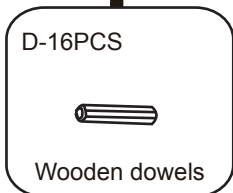
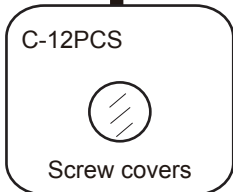
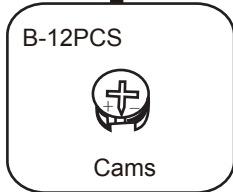
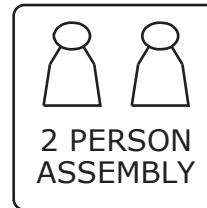

## B1-4CP200

### Boffin Wooden Office Cupboard - 4 Shelf

Additional tools required:  
1 x Philips cross-head screwdriver.

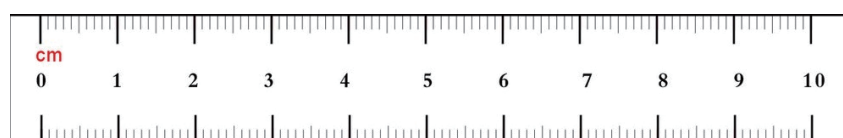

**Only tighten the screws by hand with provided allen key.  
Before use please check if fixings are tightened fully.**

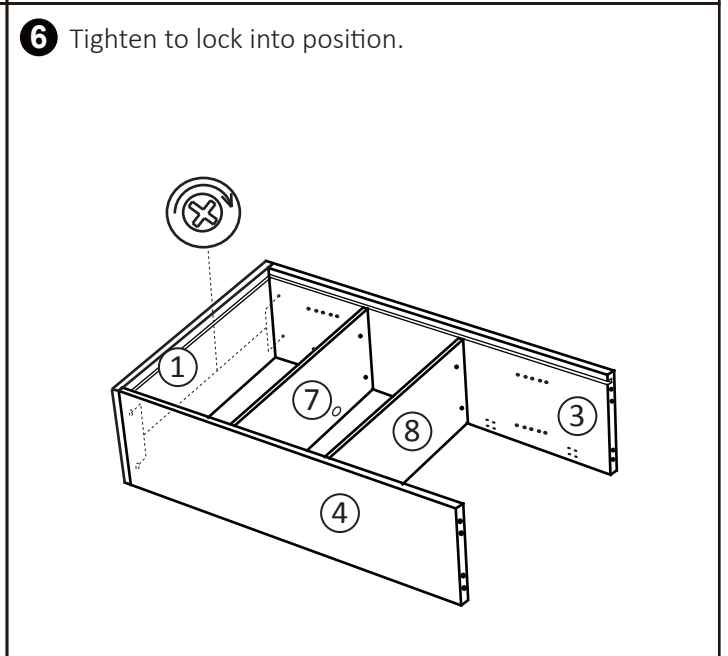
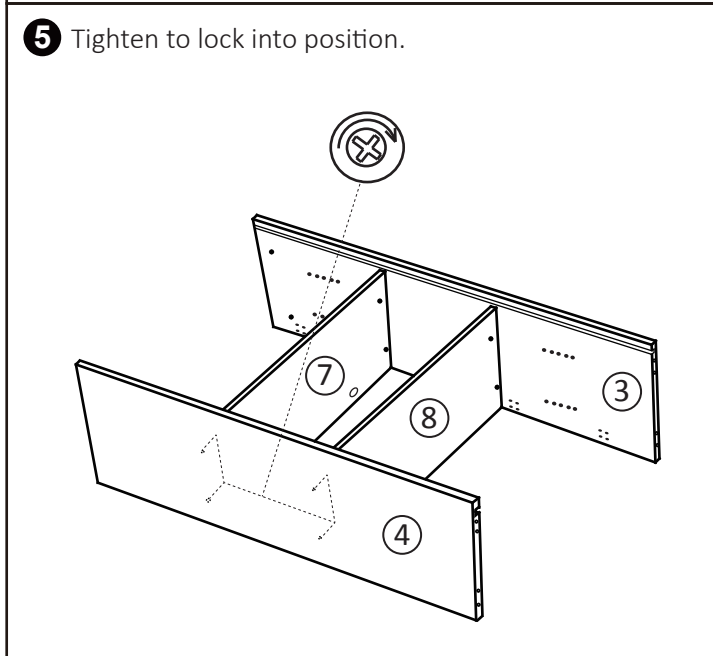
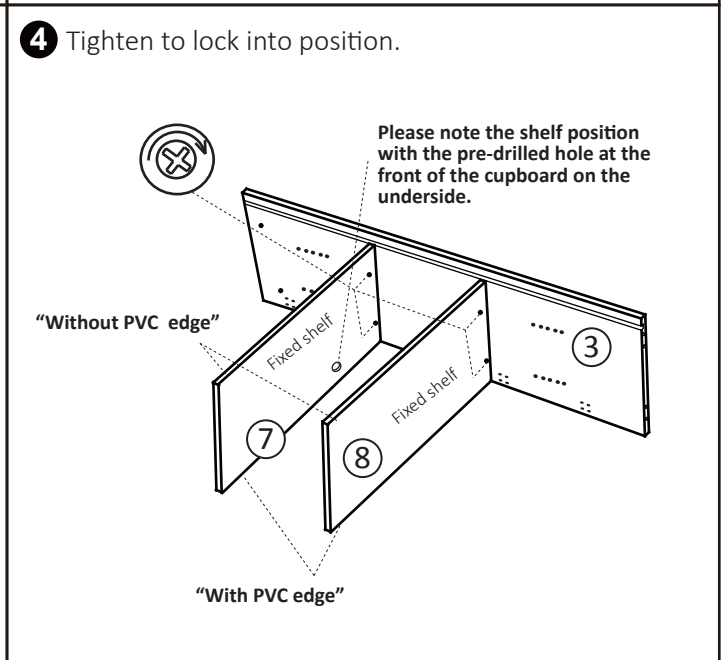
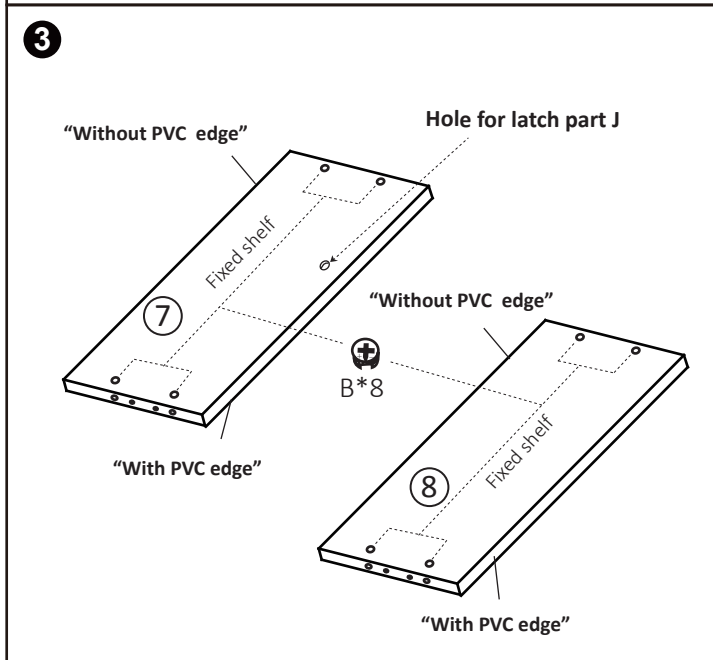
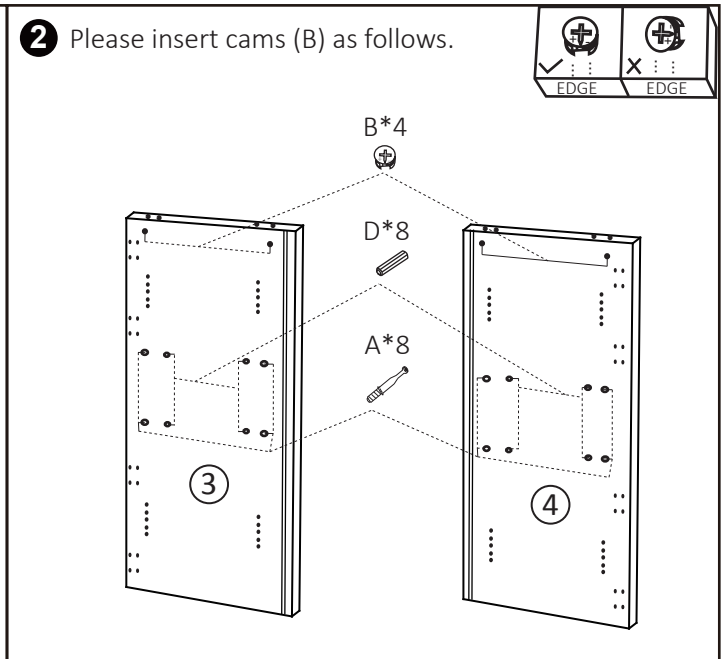
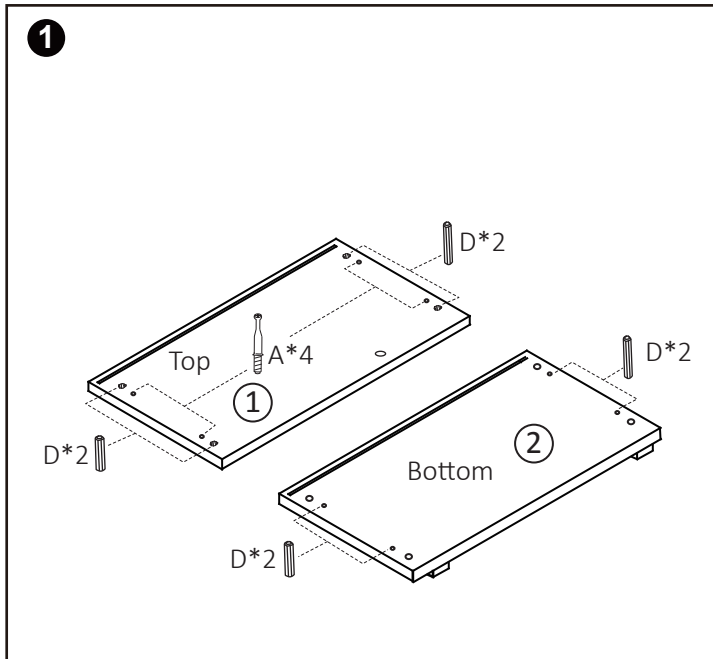

# Only tighten the screws by hand with provided allen key. Before use please check if fixings are tightened fully.

**7** Tip the bookcase onto its side. When sliding in the back, ensure it clears the shelf and fits flush into the recess of the top before proceeding to step 8.

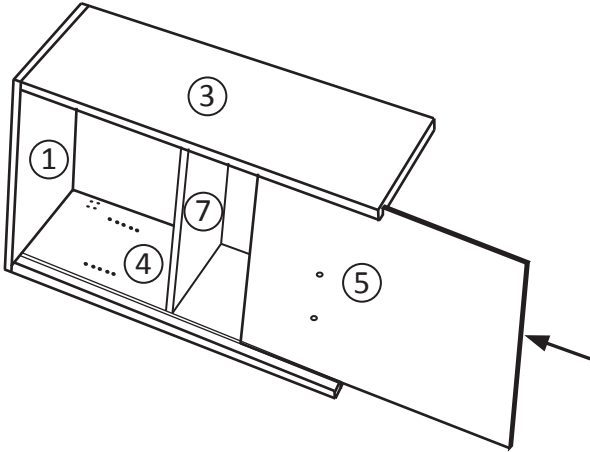

**8** If you experience difficulty when sliding in the back panel, please loosen the fixed-shelf cam (B) and then slide in the back. When the back panel is firmly in position, please re-tighten the cam.

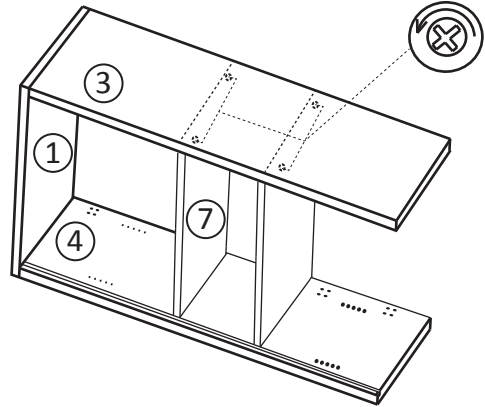

**9** Now fit the base correctly into place and again ensure the back slides into the recess in the base before putting in screw E\*4.

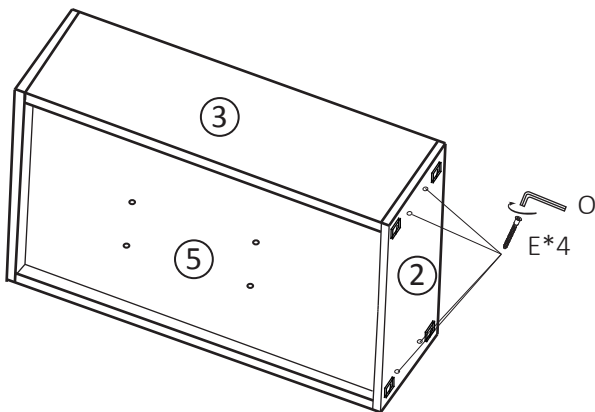

**10**

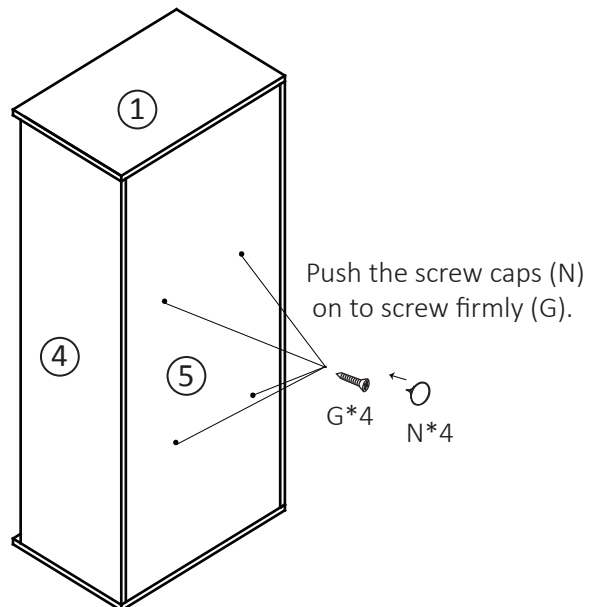

**11** Now turn the bookcase upright on its base and insert the adjustable shelves.

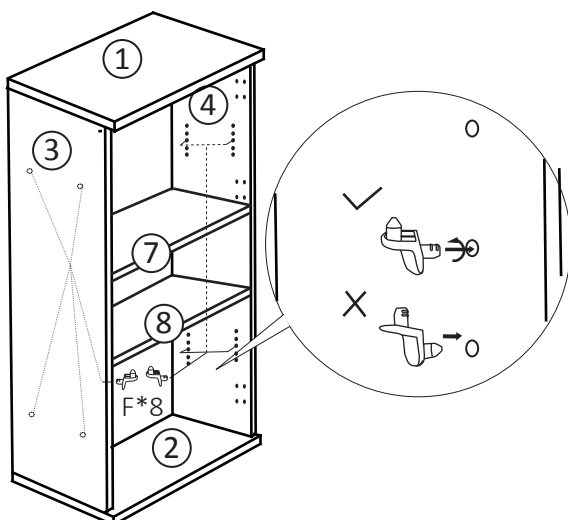

**12**

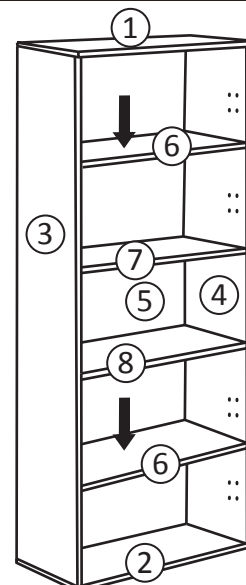

Note: Please fit screw covers (C) on to visible/exposed cams (B) to complete assembly.

**Only tighten the screws by hand with provided allen key.  
Before use please check if fixings are tightened fully.**

